



HEES W230-131-1 * In case of Inverter or V.V.V.F Motor: Performance data is based on sine wave tests. A4(210mm X 297mm)

Type :	HLP-45/4
Full Load Torque :	24.7 Kg-m
Load moment of Inertia (J) :	37.039 Kg-m ²
Motor moment of Inertia (J) :	0.546 Kg-m ²

45kW	60HP	4P	60 Hz
Speed at Full Load : 1775 RPM			
Rated Voltage	440V	380V	220V
Full Load Current	75.8A	87.8A	151.6A

SPEED VS TORQUE & CURRENT CURVE

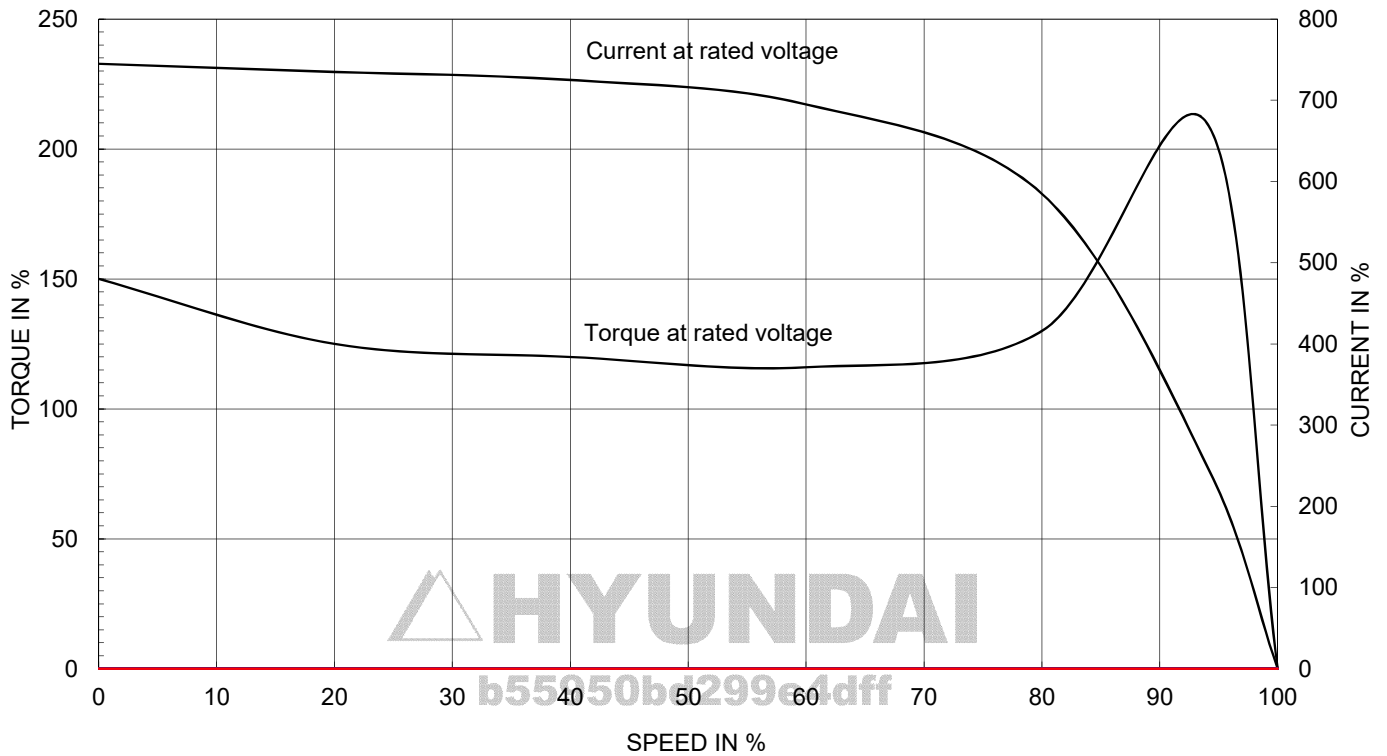

OUTPUT VS EFF., P.F & CURRENT CURVE

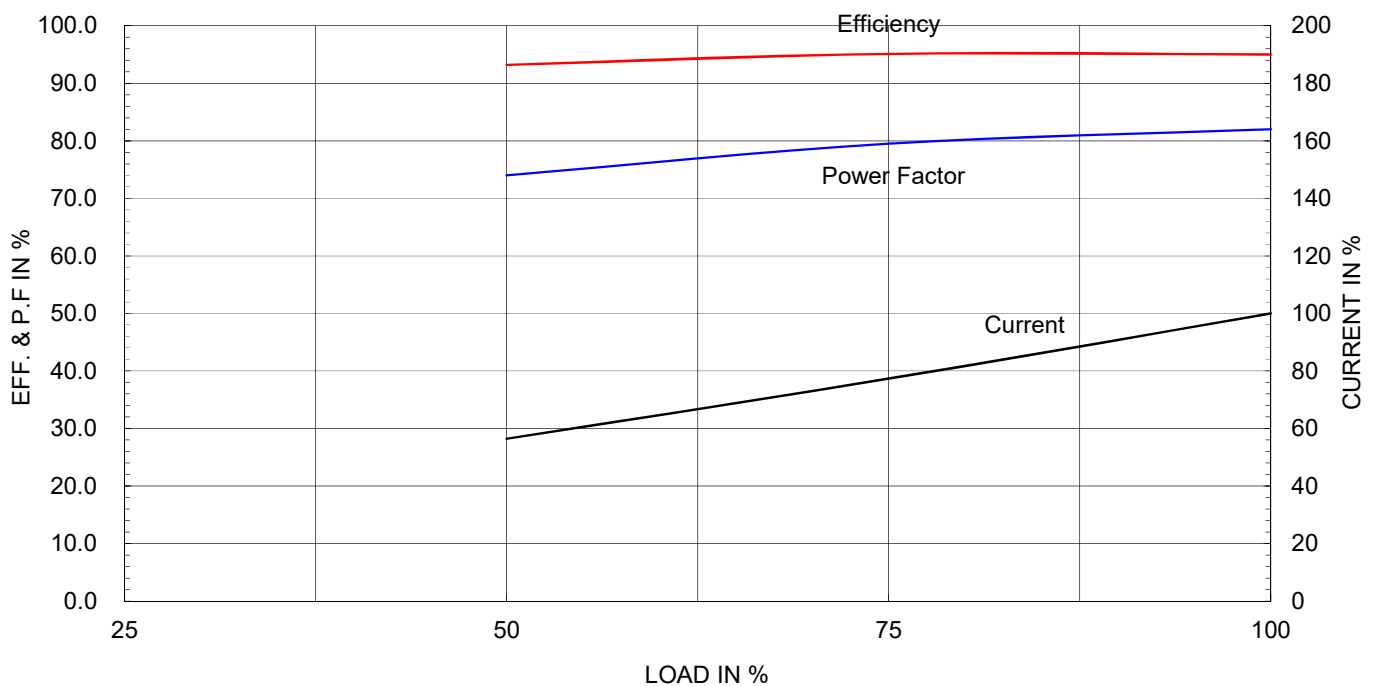

1			2		3	4			
▽	50S	REV	DATE	CONTENTS		REVD BY	CHKD BY	CHKD BY	APPD BY
▽▽	12.5S								
▽▽▽	3.2S								
▽▽▽▽	0.4S								

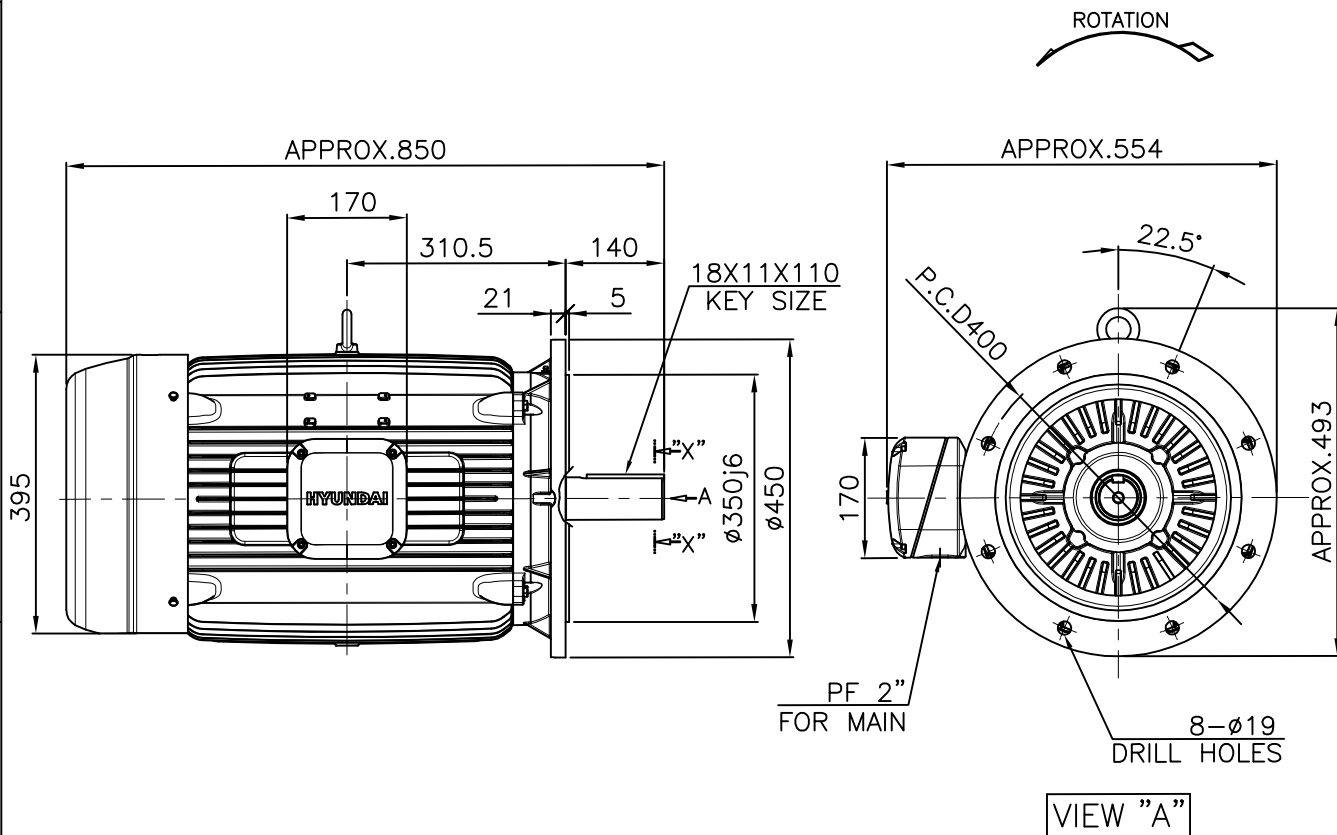

NOTE

1.TOLERANCE :

FLANGE HOLE	$\phi 19 \begin{smallmatrix} +0.52 \\ 0 \end{smallmatrix}$
RABBET DIAMETER	$\phi 350 \pm 0.018$
SHAFT DIAMETER	$\phi 60 \begin{smallmatrix} +0.030 \\ +0.011 \end{smallmatrix}$
KEYWAY WIDTH	$18 \begin{smallmatrix} 0 \\ -0.043 \end{smallmatrix}$
KEYWAY DEPTH	$7 \begin{smallmatrix} +0.2 \\ 0 \end{smallmatrix}$
KEY WIDTH	$18 \begin{smallmatrix} 0 \\ -0.043 \end{smallmatrix}$
KEY HEIGHT	$11 \begin{smallmatrix} 0 \\ -0.110 \end{smallmatrix}$

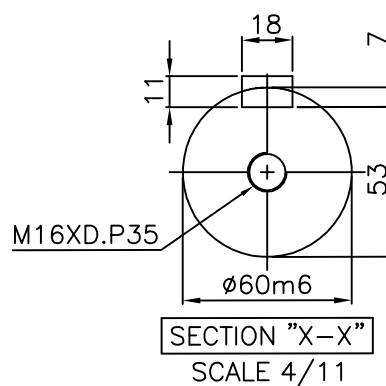

APPD BY	S.K.HAN	UNIT	mm	SUBJECT	KS Fr.200LL-4~20P	DWG SIZE
CHKD BY	I.K.KIM	SCALE	1/11	TITLE		A4 (1:11)
CHKD BY	S.H.LEE	PROJEC'N	3각법 (3rd Angle)			
DSND BY	S.R.KIM	DATE	2020.06.19			
				REF. NO		Sheet No. of
				DWG NO	LM-T1207B5PLV01	Revision No. 0

THIS DRAWING IS PROPRIETARY TO HYUNDAI ELECTRIC. NO PART OF THIS DRAWING
MAY BE REPRODUCED WITHOUT THE PERMISSION OF HYUNDAI ELECTRIC.

HYUNDAI
ELECTRIC

본 도면은 현대일렉트릭(주) 재산이므로
허가없이 복사할 수 없음 (취급유의)

